

SCALE IN FEET

SHOW AS OF 10/2/09

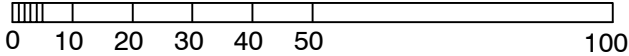

DRAWINGS 10/02/09 bm
AS OF
Drawing Started on: 08/07/07 KPC

SHOW LEGEND & BOOTH COUNT

Inventory as of 10/02/2009

Dimension	Size	Qty	SqFt
8x10'	80	96	7,680
19x20'	380	2	760
Totals:		98	8,440

BUILDING LEGEND

- - TYPICAL COLUMNS
- ☎ - REGISTRATION
- ♀ - WOMENS RESTROOM
- ♂ - MENS RESTROOM
- ☎ - TELEPHONE
- ⬆ - ESCALATOR
- ⬆ - ELEVATOR

LINETYPE LEGEND

- ROLL-UP DOORS
- AIRWALLS
- LOW CEILINGS
- CEILING BEAMS
- OPEN ABOVE

FREEMAN

4493 FLORENCE ST.
DENVER, COLORADO 80228
Phone: 303-329-3442
Fax: 303-307-0529

DENVER
DRAFTING & DESIGN

File Name:	MICEC0308.dwg
Show Name:	MEETINGS INDUSTRY COUNCIL ED CONF
Show Dates:	03/25/08
Facility:	ADAM'S MARK
Job Number:	198131
Acct. Exec:	TM

Scale: 1/32" = 1'

DISCLAIMER
EVERY EFFORT HAS BEEN MADE TO ENSURE THE ACCURACY OF ALL INFORMATION CONTAINED ON THIS FLOORPLAN. HOWEVER, NO WARRANTIES, EITHER EXPRESSED OR IMPLIED, ARE MADE WITH RESPECT TO THIS FLOORPLAN. IF THE LOCATION OF BUILDING COLUMNS, UTILITIES OR OTHER ARCHITECTURAL COMPONENTS OF THE FACILITY IS A CONSIDERATION IN THE CONSTRUCTION OR USAGE OF AN EXHIBIT, IT IS THE SOLE RESPONSIBILITY OF THE EXHIBITOR TO PHYSICALLY INSPECT THE FACILITY TO VERIFY ALL DIMENSIONS AND LOCATIONS.
© COPYRIGHT 2008, FREEMAN DESIGN AND ARCHITECTURE. ALL RIGHTS RESERVED.

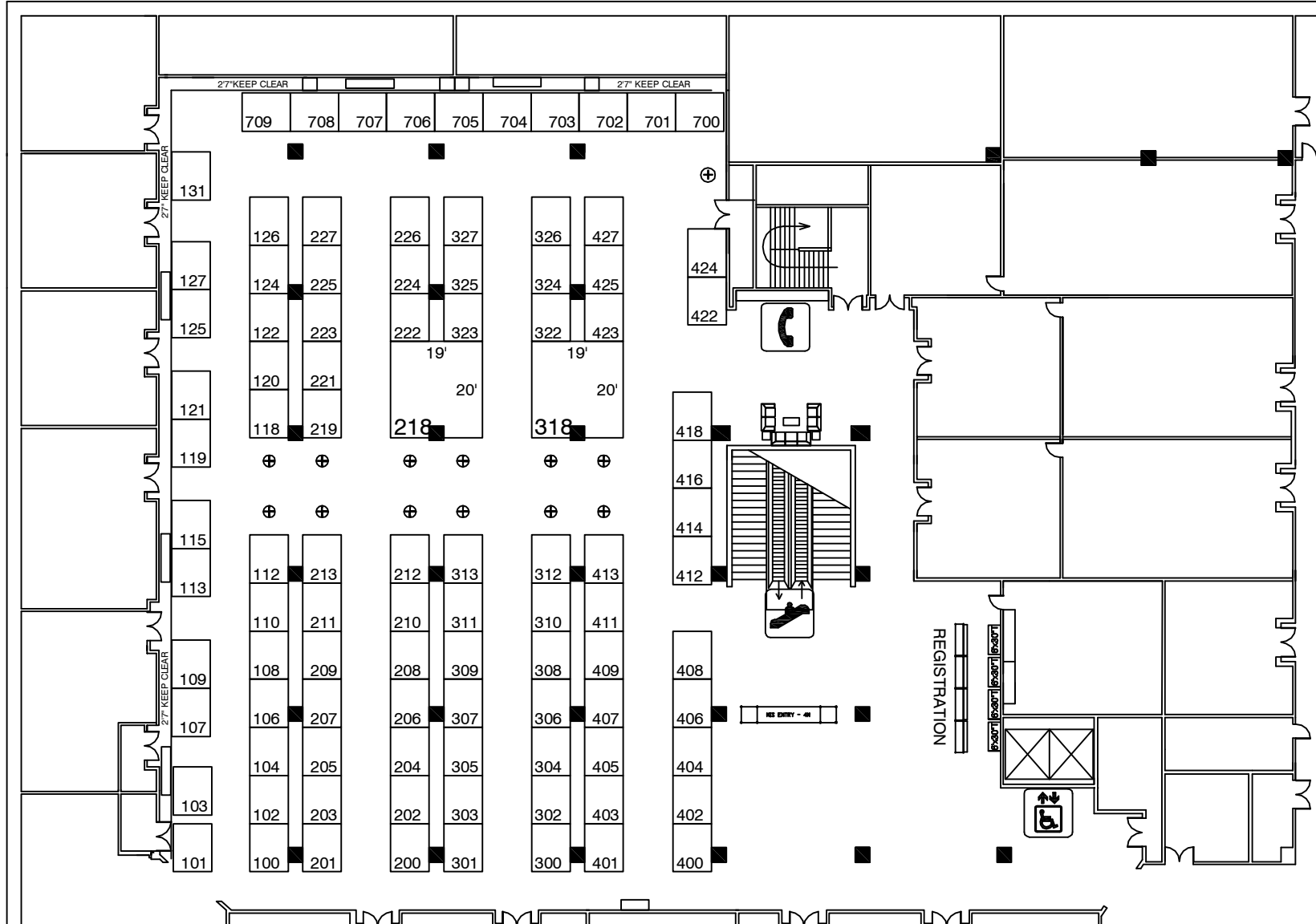

**MEETINGS INDUSTRY COUNCIL OF COLORADO
EDUCATIONAL CONFERENCE & TRADE SHOW
MARCH 17, 2010**